

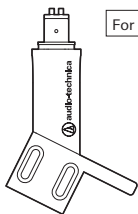

## AT-HS4

### User Manual / Headshell

For half-inch mount cartridges



audio-technica

This product is used for straight tonearm turntables. For compatible models, please visit [Audio-Technica.com](http://Audio-Technica.com).

Thank you for purchasing this Audio-Technica product. Before using the product, read through this user manual to ensure that you will use the product correctly. Please keep this manual for future reference.

### ■ Safety precautions

- Keep the product out of the reach of small children to avoid accidental ingestion of screws, nuts and washers, or damage to product.
- Do not use the product for any purpose other than to mount a phono cartridge.
- Do not put the product in a location where it is exposed to direct sunlight, near heating devices, or in places with high temperatures, high humidity, or high concentrations of dust.
- Do not attempt to disassemble or modify the product.
- Do not subject the product to strong impact.

### ■ Name of each part

#### Side view

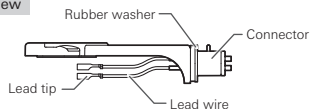

#### Top view

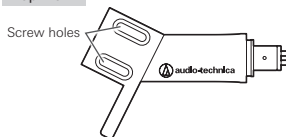

### ■ Specifications

Material	: Aluminum
Weight	: Approx. 8.5 g (0.30 oz) (including lead wire)
Accessories	: Cartridge installation slotted screw (10.0 mm x 2 and 8.0 mm x 2), Nut x 2, Plastic washer x 2

Specifications are subject to change without notice due to improvements.

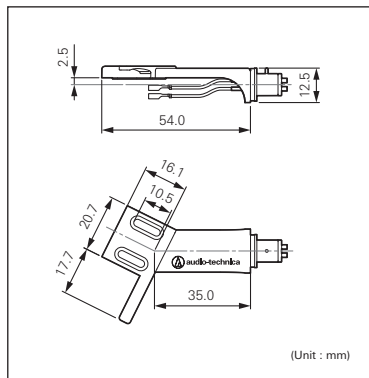

### ■ How to install

1. Mount a cartridge onto the headshell using the cartridge installation slotted screw and plastic washer provided, and tighten lightly so that cartridge position can be adjusted.
  - When using a cartridge without threaded inserts, use screws and nuts to install the cartridge.
  - Take care that the screws are short enough so as not to touch and damage the record.
  - Read the user manual of the cartridge.

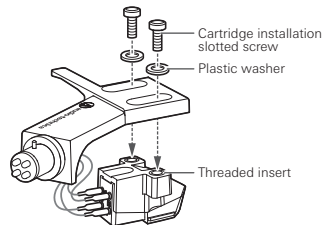

2. Slide the lead tips over the cartridge connections.

- Do not apply heat.
- Use tweezers, small pliers, and non-magnetic screwdriver(s) to mount the headshell/cartridge.
- If a lead tip is loose, flatten it out slightly to attach it.

#### ● Layout of headshell leads

#### Front view

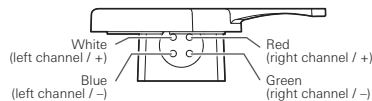

3. Loosen screws with a non-magnetic screwdriver and adjust for overhang. Tighten the screws firmly when position is fixed.

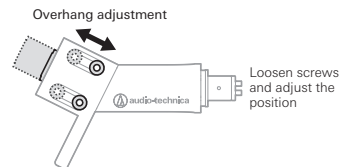

### Underside of headshell

Mount the cartridge so it is parallel to the headshell.

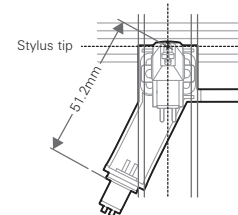

### Front of headshell

Mount the cartridge so it is perpendicular to the top of the headshell.

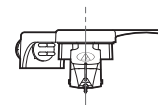

4. Attach the headshell to the tonearm.

5. Refer to the turntable's user manual and adjust the tonearm balance, tracking force and anti-skate.

Other language versions of this manual are available for download at <http://eu.audio-technica.com/>

**Audio-Technica Corporation**  
2-46-1 Nishi-naruse, Machida, Tokyo 194-8666, Japan  
[www.audio-technica.com](http://www.audio-technica.com)  
©2018 Audio-Technica Corporation  
Global Support Contact: [www.at-globalsupport.com](http://www.at-globalsupport.com)