



## Device description

PX725 Keyboard Hub is a device which connects the controller PX340 or PX710M with the additional input modules PX723 Keyboard 8, PX734 Light & Movement Sensor and PX778 Extension module 8ch. The connector has two independent buses, to which max. 32 input modules each can be controller in series (in total max. 64 modules).

The configuration of additional devices is from the level of the PxDesigner application.

## Technical drawing

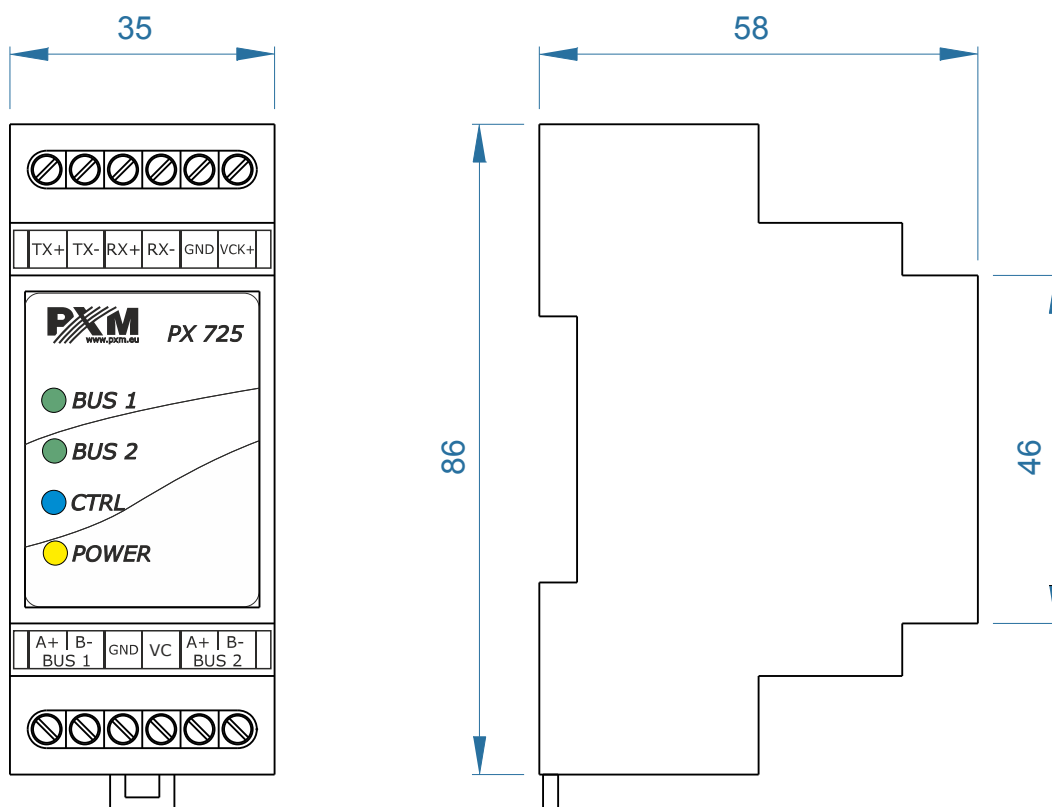

# Connection diagram

## a) connecting the PX723 and PX734 to the Keyboard Hub

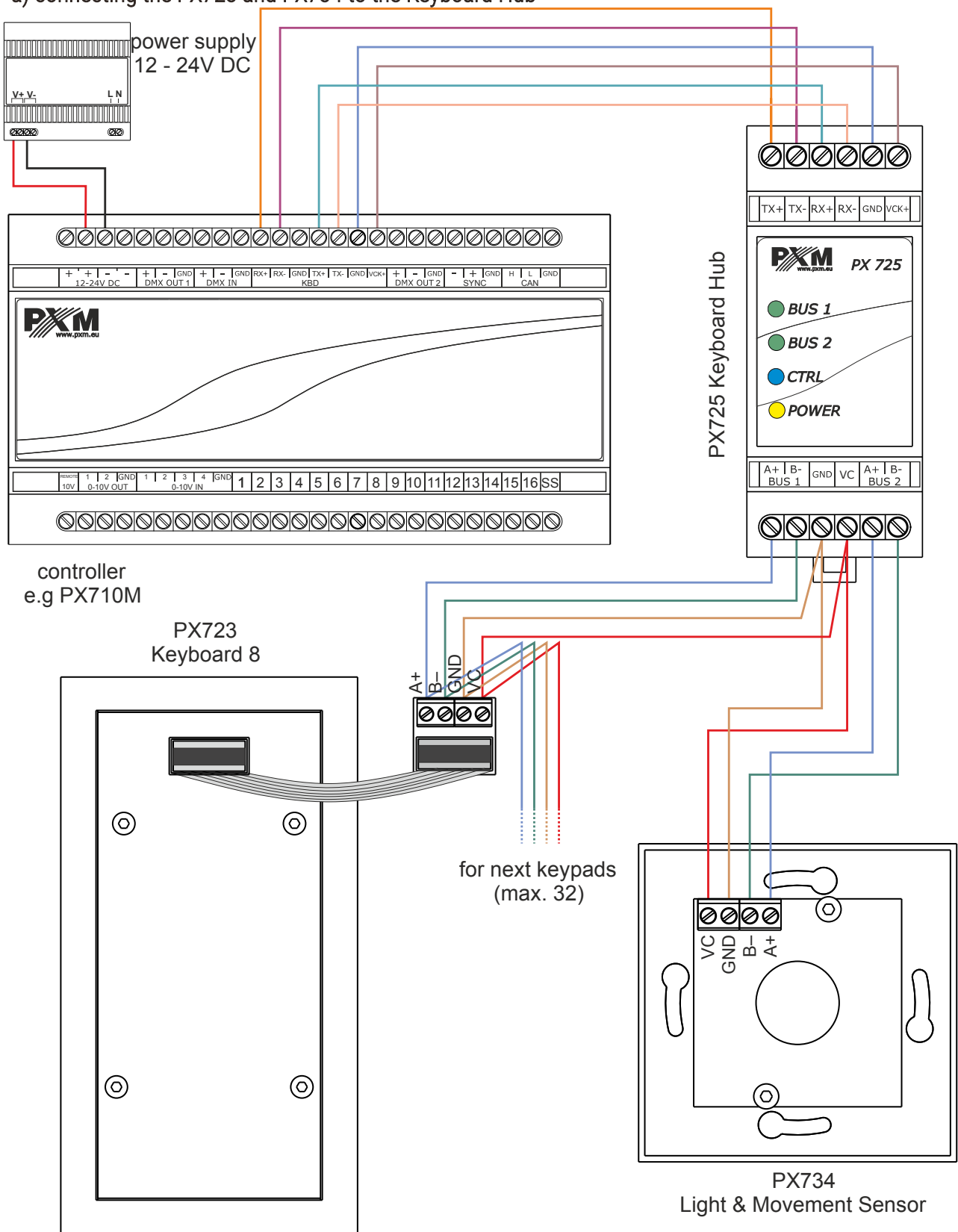

b) connecting the PX778 to the Keyboard Hub

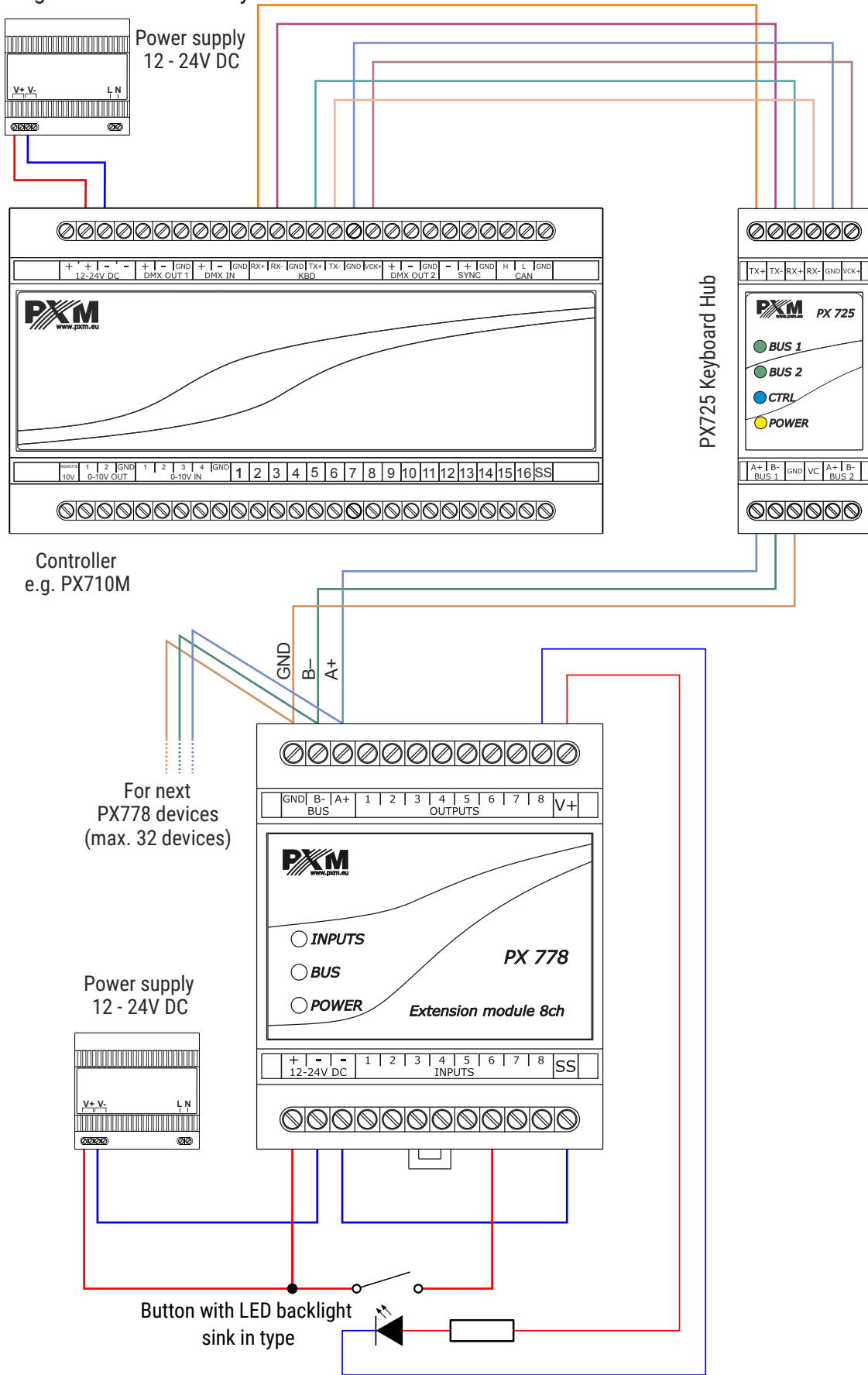

## Technical data

---

type	PX725
power supply	from controller (12 – 24V DC)
maximum number of the devices	64 (max. 32 for one line PX725)
method of programming	with use the PxDesigner
cooperation with controller	PX340, PX710M
weight	0.15kg
dimensions	width: 35mm height: 86mm depth: 58mm