



MME 865-1



Quick Guide
 Kurzanleitung
 Guide de démarrage rapide
 Guida rapida
 Instrucciones resumidas
 Instruções resumidas
 Beknopte gebruiksaanwijzing
 Krótka instrukcja obsługi
 Snabbguide

Kort vejledning
 Pikaohje
 Γρήγορος οδηγός
 Kısa Kılavuz
 Краткая инструкция
 快速指南
 快速使用指南
 クイックガイド
 퀵 가이드

Sennheiser electronic GmbH & Co. KG

Am Labor 1, 30900 Wedemark, Germany
www.sennheiser.com

Printed in Germany
Publ. 03/19, 583919/A01

SENNHEISER

Setup

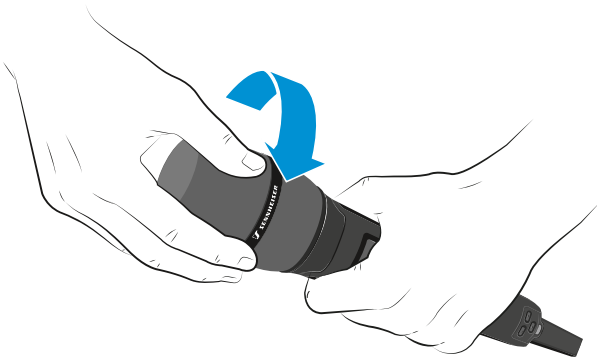
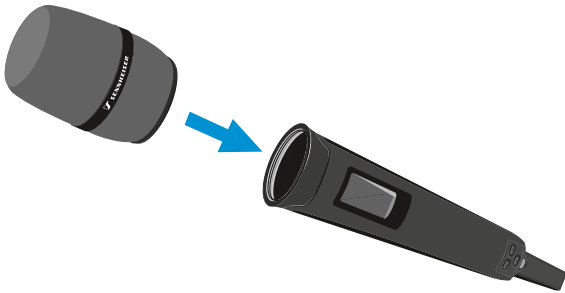

In the box



1 x Protective cap

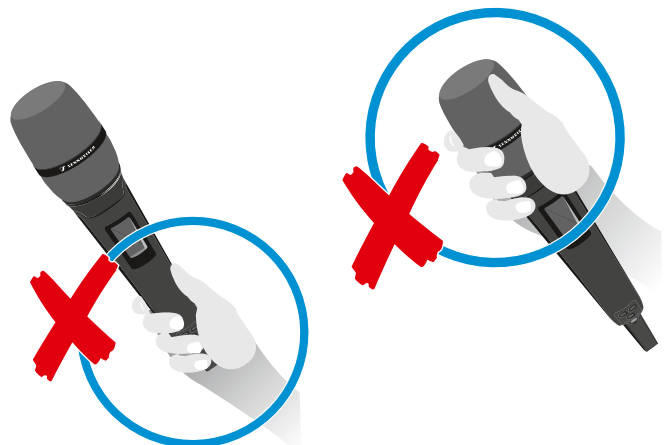
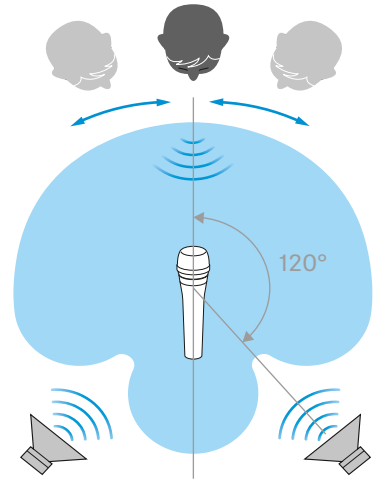
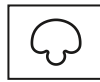

Cleaning

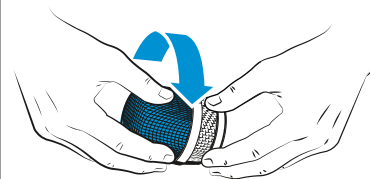
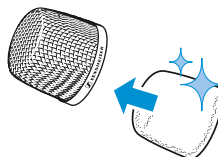
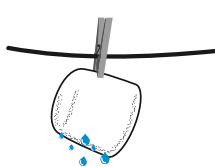
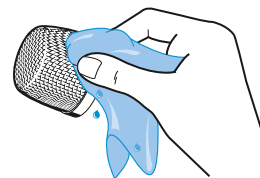
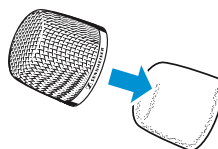
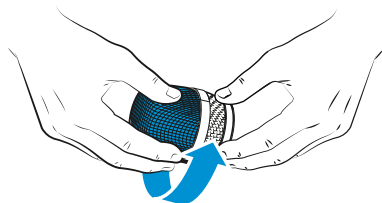

Accessories



MZW 5000

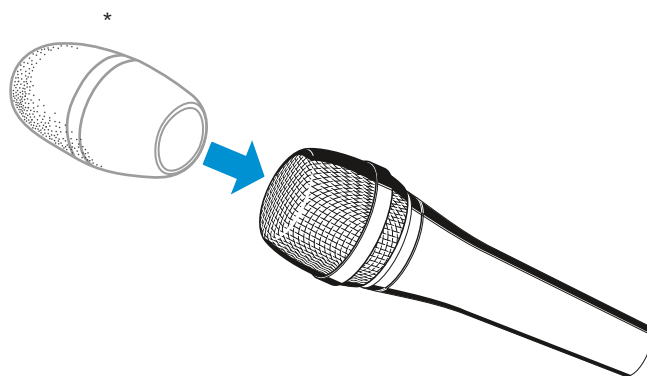
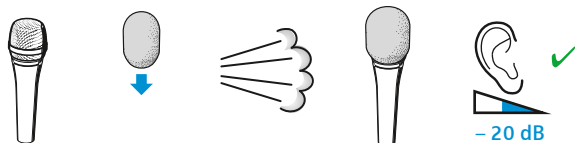

*MZW 5000 not included

Specifications

Transducer principle	pre-polarized condenser
Pick-up pattern	super-cardioid
Sensitivity	1,6 mV/Pa
Max. SPL at 1 kHz	152 dB
Dynamic range	120 dB(A)
Frequency response	40 to 20,000 Hz
Color	black
Weight	92 g

Compatible with

ew G4:	SKM 100 300 500 G4
ew G3:	SKM 100 300 500 G3
2000 series:	SKM 2000
Digital 6000:	SKM 6000
Digital 9000:	SKM 9000

Polar pattern and frequency response

