



# MAT 133 | MAT 133-S MAT 153-S

Quick Guide  
 Kurzanleitung  
 Guide de démarrage rapide  
 Guida rapida  
 Instrucciones resumidas  
 Instruções resumidas  
 Beknopte gebruiksaanwijzing  
 Krótka instrukcja obsługi  
 Snabbguide

Kort vejledning  
 Pikaohje  
 Γρήγορος οδηγός  
 Kısa Kılavuz  
 Краткая инструкция  
 快速指南  
 快速使用指南  
 クイックガイド  
 퀵 가이드

**SENNHEISER**



[www.sennheiser.com/download](http://www.sennheiser.com/download)

Sennheiser electronic GmbH & Co. KG

Am Labor 1, 30900 Wedemark, Germany  
[www.sennheiser.com](http://www.sennheiser.com)

Printed in Germany, Publ. 11/23, 549118/A04

## In the box

MAT 133

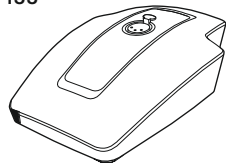

MAT 133-S

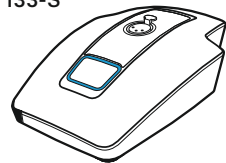

MAT 153-S

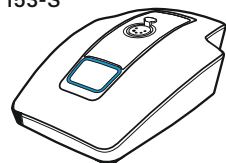

## LED status

MAT 133-S  
MAT 153-S



- lights up green: microphone active
- lights up red\*: microphone muted

\*This function is not supported by all PAs/DSPs.

## Mounting

Sennheiser goosenecks\*:  
MZH 30xx | MEG 14-40(-L)

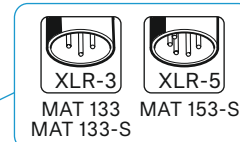
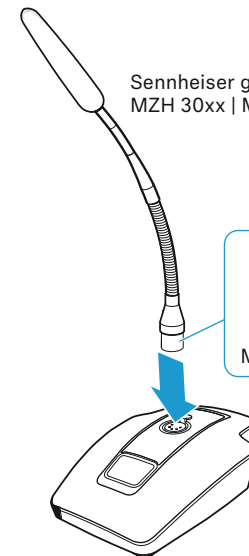

\*not included

## Setup

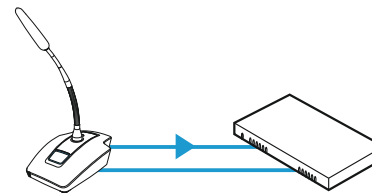
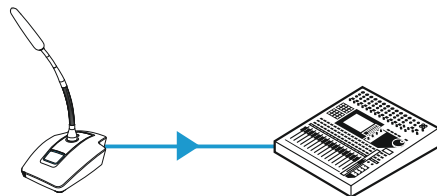

MAT 133-S  
MAT 153-S

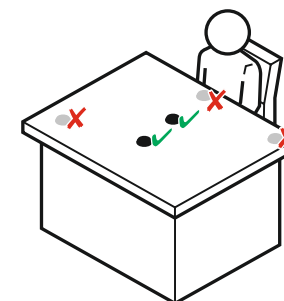
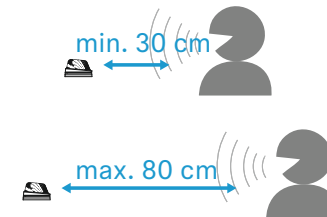
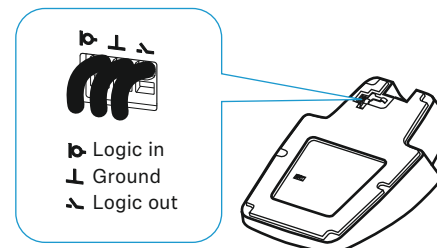
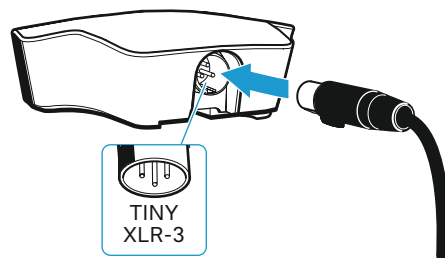

see Instruction manual of the microphone series\*\*

## Microphone behavior

MEB 114-S

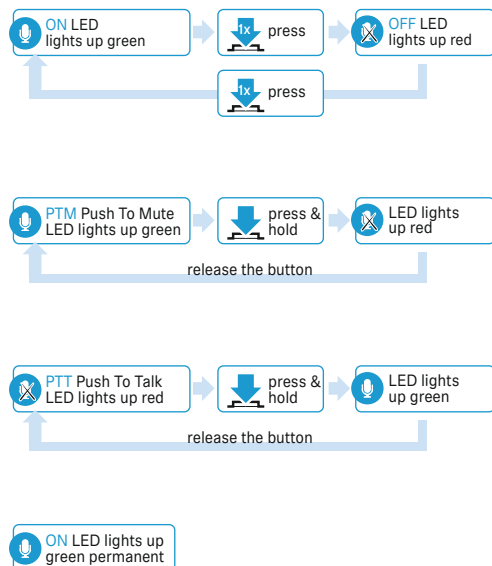
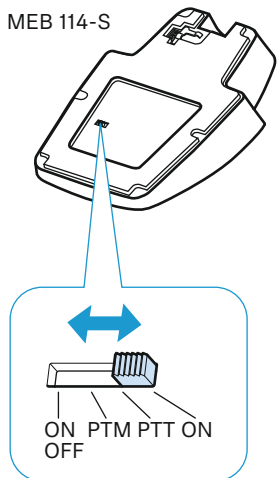

## Specifications

	MAT 133	MAT 133-S	MAT 153-S
Current consumption	1.9 mA	3.7 mA	
Power supply	48 V phantom power (P48)		
Logic output	high level output voltage > 2.4 V low level output voltage < 0.4 V		
Connector	MIC IN: XLR-3F MIC OUT: XLR-3M 3x terminal	MIC IN: XLR-5F MIC OUT: XLR-3M 3x terminal	
Temperature	operation: -10 °C – +50 °C storage: -25 °C – +70 °C		
Dimensions	120 x 43 x 170 mm		
Weight	approx. 1210 g		