



SENNHEISER

HM 200

Headset microphone

- Quick Guide
- Kurzanleitung
- Guide de démarrage rapide
- Guida rapida
- Instrucciones resumidas
- Instruções resumidas
- Beknopte gebruiksaanwijzing
- Krótką instrukcja obsługi
- Snabbguide
- Kort vejledning
- Pikaohje
- Σύντομες οδηγίες
- Kısa Kılavuz
- Краткая инструкция
- 快速指南
- 快速使用指南
- クイックガイド
- 요약 안내서

Sennheiser electronic GmbH & Co. KG

Am Labor 1, 30900 Wedemark, Germany
www.sennheiser.com

Printed in Germany, Publ. 03/21, 587496/A01

In the box

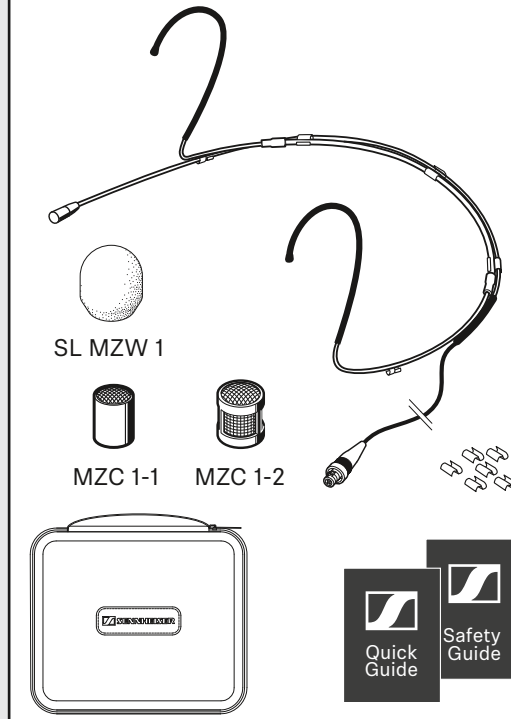

Setup



Setup

Frequency caps

MZC 1-2



+ 4 dB

MZC 1-1



+ 2 dB

Windshield



SL MZW 1



- 10 dB

Setup

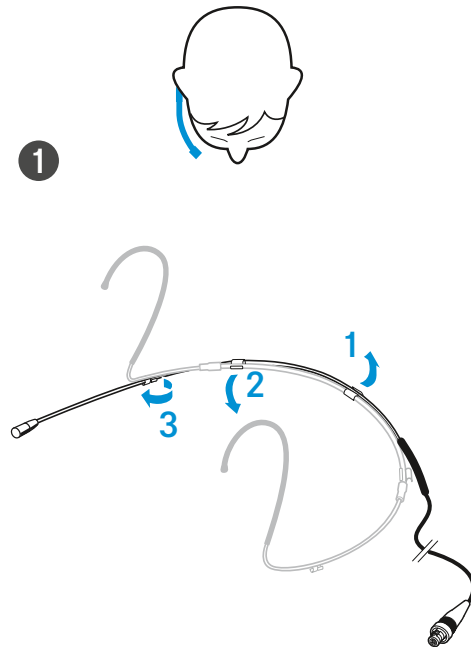

2

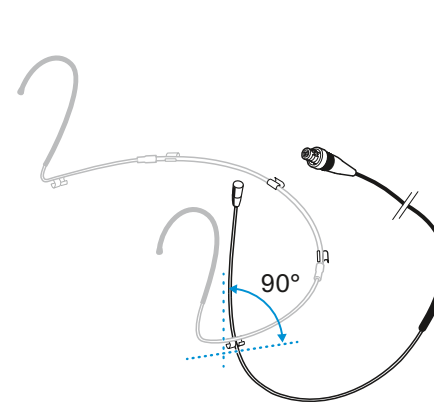

3

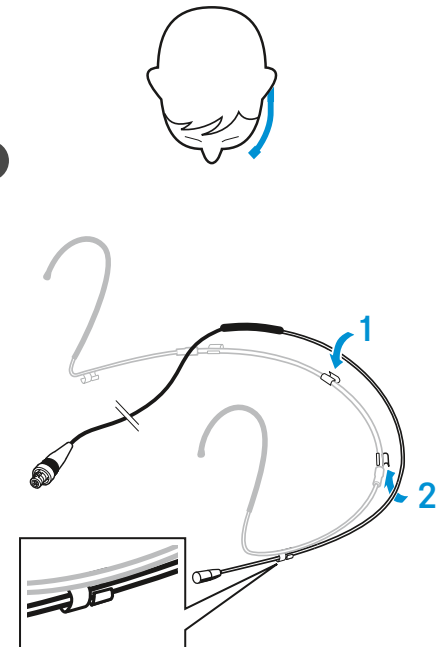

Cleaning

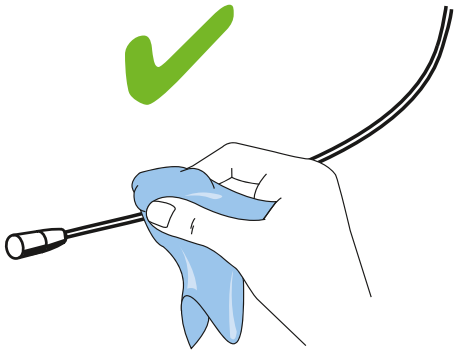

Specifications

Frequency response	20 – 20,000 Hz ±3 dB
Pick-up pattern	omni-directional
Nominal impedance	1 kΩ
Min. terminating impedance	4.7 kΩ
Sensitivity	5 mV/Pa ±3 dB
Diameter of mic capsule	3.3 mm
Max. sound pressure level	143 dB
Equivalent noise level	27 dB(A)
Supply current	approx. 240 μA
Power supply	4.5 – 15 V
Operating temperature	-10 °C to +50 °C
Storage temperature	-20 °C to +70 °C
Relative humidity	max. 95 %
Cable length	1.6 m
Diameter of boom arm	1.1 mm
Weight	approx. 13 g
Connector	3-Pin connector

Polar pattern

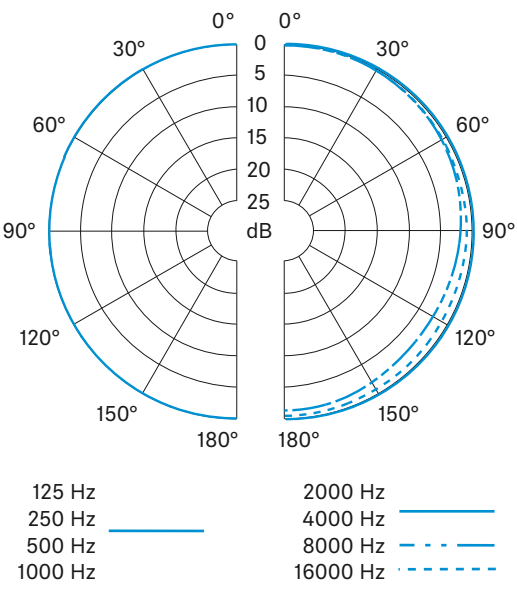

Frequency response

