

GreenConnect Wireless 0-10V Wall Dimmer



Description

GreenConnect delivers simple wireless lighting control by adding wireless control to virtually any switching or dimming load. Compatible with various lamp fixtures and load control devices, GreenConnect offers a scalable and flexible wireless solution to meet the control needs of virtually any space. No new wiring, room controller, hub, or commissioning is required. Ideal for retrofits and new construction.

The GreenConnect Wireless 0-10V Wall Dimmer (ZB700) is a robust Decora® dimmer switch. Use it to control local lighting loads, including high inrush LED, or pair it with another ZB700 in a GreenConnect network for multi-way switching or dimming.

Features

- Use as a standalone dimmer switch or pair with another switch, dimmer, or sensor in a GreenConnect network of up to 16 devices
- Compatible with multiple 0-10V dimming load types
- Robust and reliable mechanically-held latching High Inrush Stability (HIS) relay for large commercial loads
- Classic Decora® rocker with dimming bar for simple ON/OFF and raise/lower control
- LED indicators for light level and locating in a dark room
- Easy installation in any single-gang device box
- Includes White, Ivory, and Light Almond face plates
- Color change kits available in White, Ivory, Light Almond, Gray, Black, and Brown
- Complies with IEEE 802.15.4 standards for domestic and international wireless networks
- Code compliant energy management functionality—can be used as a component in a system to meet code requirements for IECC, ASHRAE 90.1, and 2025 Title 24, Part 6 space/area control, dimming, manual-ON/OFF, occupancy/vacancy control and automatic shutoff requirements

Wiring Diagram

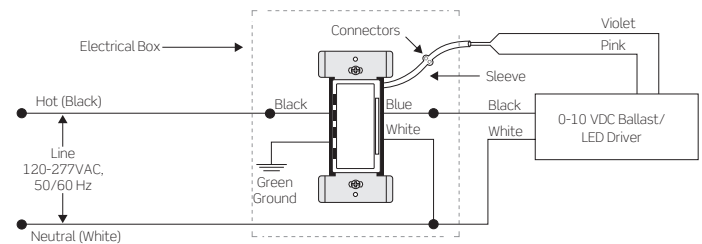

User Interface

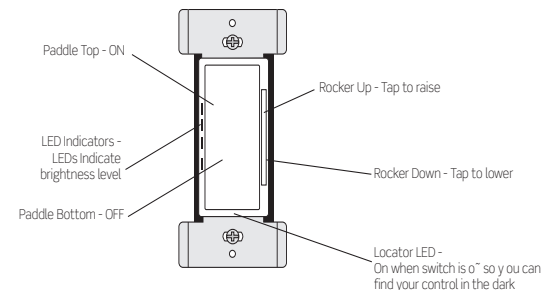

Dimensions Diagram

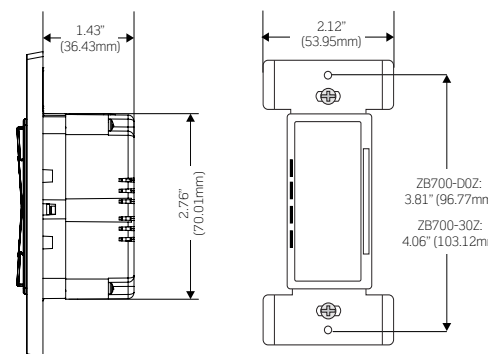

Leviton Manufacturing Co., Inc. Lighting & Controls

10385 SW Avery Street, Tualatin, OR 97062 tel 503-404-5500 tech line (8:30AM-7:30PM ET Mon-Fri) 800-824-3005
©2025 Leviton Manufacturing Co., Inc. All rights reserved. Subject to change without notice.

Specifications

Electrical	ZB700-D0Z	ZB700-30Z
Input Voltage/Frequency	120-277VAC, 50/60Hz	347VAC, 50/60Hz
Input Current		
120V	Standby: 0.2W, Max: 0.5W+Load Current	Not rated for use
277V	Standby: 0.3W, Max: 0.6W+Load Current	Not rated for use
347V	Not rated for use	0.5W + Load Current
Load Ratings		
LED, CFL, Electronic Ballast @ 120V	8A	Not rated for use
LED, CFL, Electronic Ballast @ 277V	5A	Not rated for use
LED, CFL, Electronic Ballast @ 347V	Not rated for use	4A, 1388VA
Magnetic Ballast @ 120V	10A	Not rated for use
Magnetic Ballast @ 277V	10A	Not rated for use
Magnetic Ballast @ 347V	Not rated for use	3.45A, 1200VA
Resistive, Tungsten @ 120V	6.67A	Not rated for use
Resistive, Tungsten @ 277V	6.67A	Not rated for use
Resistive, Tungsten @ 347V	Not rated for use	6.67A
Motor @ 120V	1/4Hp (FLA 5.8A)	Not rated for use
Motor @ 277V	1/3Hp (FLA 3.0A)	Not rated for use
Motor @ 347V	Not rated for use	1/4Hp
UL Impulse Voltage	4000V	6000V
UL Pollution Degree	2	
Environmental		
Operating Temperature Range	32° to 104° F (0° to 40° C)	
Storage Temperature Range	-40° to 185° F (-40° to 85° C)	
Other		
Energy Codes	Can be used as a component in a system to meet energy code requirements for IECC, ASHRAE 90.1, and 2025 Title 24, Part 6 space/area control, dimming, manual-ON/OFF, occupancy control and automatic shutoff requirements	
IP Rating	IP10	
Network Connections	IEEE 802.15.4, 2.4Ghz, wireless, mesh network up to 75' range between device	
Weight	0.25lbs (0.11kg)	
Warranty	5-Year	

Ordering Information

GreenConnect Wireless 0-10V Wall Dimmer	
Cat. No.	Description
ZB700-D0Z	GreenConnect Wireless 0-10V Wall Dimmer, 120-277VAC, 50/60Hz, 10A Load, 0-10V Sinking, 50mA, White, Light Almond, Ivory
ZB700-30Z	GreenConnect Wireless 0-10V Wall Dimmer, 347VAC, 50/60Hz, 4A Load, 0-10V Sinking, 50mA, White, Light Almond, Ivory
DDKIT-00x*	Decora Color Change Kit

*Color change kits available in the following colors: White (-W), Ivory (-I), Light Almond (-T), Gray (-G), Black (-E), and Brown (-B). To order, replace x with the color suffix.

Leviton Manufacturing Co., Inc. Lighting & Controls

10385 SW Avery Street, Tualatin, OR 97062 **tel** 800-736-6682 **tech line** (6:00AM-4:00PM PT Mon-Fri) 800-959-6004

Leviton Manufacturing Co., Inc. Global Headquarters

201 North Service Road, Melville, NY 11747-3138 **tel** 800-323-8920 **tech line** (8:00AM-10:00PM ET Mon-Fri, 9:00AM-7:00PM ET Sat, 9:00AM-5:00PM ET Sun) 800-824-3005

Visit our Website at: www.leviton.com/greenconnect

©2025 Leviton Manufacturing Co., Inc. All rights reserved. Subject to change without notice.

LES-G-10748/E25-aa