

Included Components

1. DHXR4 x1
2. Antennas x2
3. Rack Ears x2
4. 1/4" to 1/4" Audio Cable x1
5. Power Supply x1
6. BNC Connectors x2
7. BNC Cables x2
8. Screws x6
9. Antenna Plugs x2
10. Quick Start Guide x1

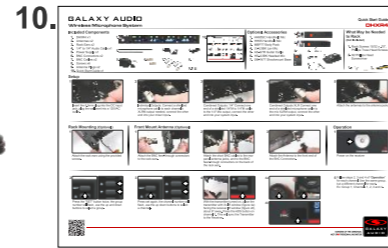

Optional Accessories

1. HH65SC Handheld Mic
2. HH65 Handheld Mic
3. MBP77 Body Pack
4. LV-U3BK Lav Mic
5. AS-GTR Guitar Cable
6. HS-U3BK Headset Mic
7. SM-W77 Shockmount Base



What May be Needed to Rack (Not Included)

1. Rack Screws 10/32 x .75", Phillips Truss Head Screws
2. #2 Phillips Head Screwdriver



Setup



1 Insert the 5.5mm plug into the DC input jack, plug the wall wart into a 120VAC outlet.



2 Individual Outputs: Connect a shielded microphone cable to each channel's XLRM output needed, connect the other end into your mixer input.



3 Combined Outputs: 1/4" Connect one end of a shielded 1/4"M to 1/4"M cable to the 1/4" Mix output, connect the other end into your system input.



4 Combined Outputs XLR Connect one end of a shielded microphone cable to the mix XLRM output, connect the other end into your system input.



5 Attach the antennas to the antenna jacks

Rack Mounting (Optional)



1 Attach the rack ears using the provided screws.

Front Mount Antenna (Optional)



1 Attach the BNC feed-through connectors to the rack ears.

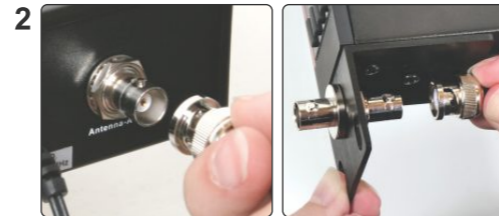

2 Attach the short BNC cables to the rear panel antenna jacks, and to the BNC feed-through connectors on the back of the rack ears.



3 Attach the Antenna to the front end of the BNC Connectors.

Operation



1 Power on the receiver

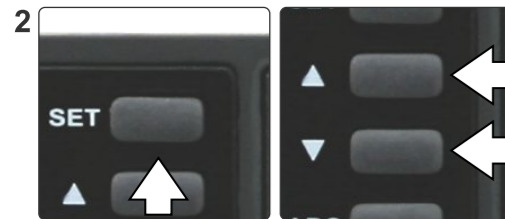

2 Press the "SET" button twice, the group number will flash, use the up and down buttons to select a group.

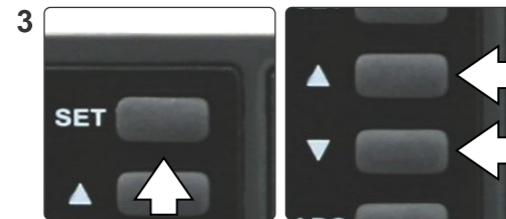

3 Press set again, the channel number will flash, use the up down buttons to select a channel.



4 With the transmitter turned on, place the transmitter with it's IR window (figure 4a) facing the receiver IR window (figure 4b), about 6" away. Press the ADS button on channel 1. This will sync the Transmitter to the Receiver.



5 Follow steps 2, 3 and 4 of "Operation" for each channel. Use the same group, but a different channel for each.
Ex: Group 1; Channels 1, 2, 3 and 4.





FAQ

- 1. Q. I'm having problems finding the best frequency for me. Where do I go to find this information?**
A. Please consult the online manual or visit: GalaxyAudio.com/support/schematics-and-frequency-charts

- 2. Q. I'm using channels on the same group and having issues.**
A. It is ok to use multiple groups if you cannot get all channels to work within one group.

- 3. Q. How do I use the Scan function?**
A. Consult the online manual for detailed instructions at: Galaxyaudio.com/assets/uploads/product-files/DHX-Manual.pdf



MAKERS OF THE ORIGINAL
HOT SPOT PERSONAL MONITOR

BE HEARD™

Other Helpful Sources

DHXR4
Product Page



DHXR4
Manual

(PDF Download)



DHXR4
Cutsheet

(PDF Download)



DHXR4
How To Video



Wireless Tips

- Maintain line of sight between the transmitter and receiver antennas.
- Do not have walls, metal objects, large crowds, etc. blocking the line of sight between the transmitter and receiver.
- Antennas on the stationary equipment should be kept several feet above the ground.
- Antennas can be mounted on stands or walls using brackets such as the ANT-LB.
- On body pack receivers/transmitters, avoid putting them in your pocket, and/or folding the antenna under the pack. The antenna should hang freely and openly.
- Keep the distance between transmitters and receivers as short as possible.
- If distances above 20-30' are unavoidable, directional antennas such as the ANT-PDL can improve reception by rejecting signals outside their pickup angle.
- Find out what TV stations are broadcasting in your area and avoid the channels they are on.
- This information is available from many sources on line, such as www.tvfool.com.
- If your receiver is showing that it is receiving RF when your transmitter is turned off, you need to move to another frequency.
- If you are using several systems, you can contact service@galaxyaudio.com for assistance in frequency coordination.

Make certain you are using fresh batteries, rechargeable batteries may be used, but they discharge at a much faster rate than alkaline.

Specifications subject to change without notice.