

PICA CUBE™ UV

DESIGNED BY THE BLACK TANK



True UV LED Black Light

With LEDs tuned to a narrow 365nm peak output, the Pica Cube UV makes fluorescent scenery, make-up and plastics glow amazingly bright! Ideally suited for theme parks, night clubs, casinos, museums and stage applications, Pica Cube UV is the smallest, pro-grade, high-powered UV light available.

The beam of the Pica Cube UV can be controlled using the included spread lenses that allow the fixture to act as an ultra-long throw fixture or opened to full flood for lighting a wide expanse of fluorescent scenery from a short distance. Full speed DMX control allows designers and technicians to fade their black light effect with a full range of theatrical-grade, flicker-free dimming.

Pica Cube™ can be powered via AC Mains (100-240VAC) using an available power-supply and controlled using standard DMX or in standalone mode via its easy-to-use on-board controls. The optional Pica Portal is capable of powering and controlling up to four Pica Cubes by providing power and data through a common Cat5 (24 gauge) cable.

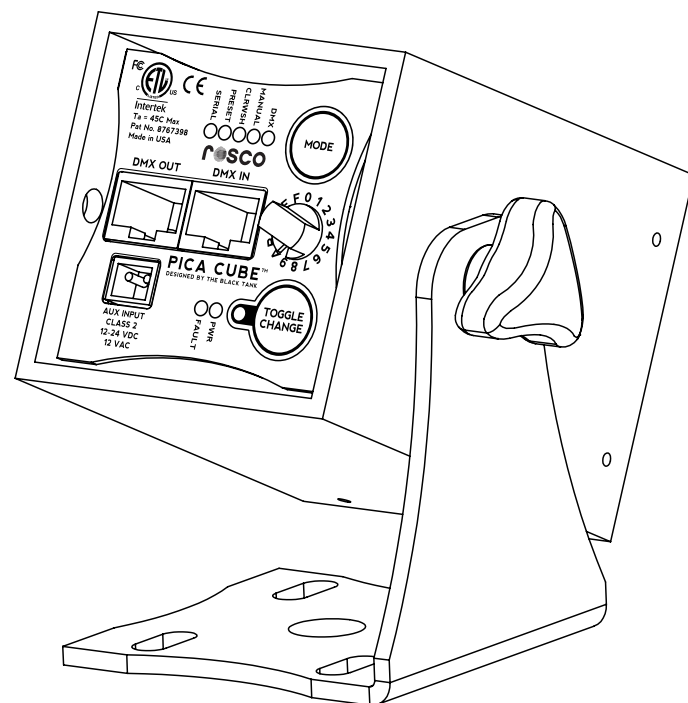

Key Features

- Optimal UV output creates stunning, bright black light effects on paint, makeup and other fluorescent materials
- Unique patented (US Patent No. 8,767,398) heat management system packs the most lumens into the smallest form factor
- Variable power input from 12-24VDC or 12VAC enables versatile power options
- Over 90 luminaires on a single 20A circuit
- Modular design easily configures in strips and arrays for maximum versatility
- Flicker-free dimming in 8 or 16 bit resolution
- Intuitive on-board controls
- Easily installed in many applications using CAT5 cable that carries Power + Data
- Full assortment of spot, medium and wide lenses included
- Novel "filament mode" mimics the delayed blackout glow of incandescent fixtures



PICA CUBE™ UV

DESIGNED BY THE BLACK TANK



SPECIFICATIONS

Input Voltage:	12-24VDC or 12VAC
Power Consumption:	20 Watt at maximum output
Power Input:	Power Adapter (100-240VAC In/12-24VDC Out) or CAT5 (Power +Data)
LED:	365nm UV LED
Data:	DMX, RJ45 Connectors
Output:	2,700mW
Wavelength:	365nm
Operation:	DMX: 8 or 16 bit DMX512/Manual: Rotary Knob
Operating Temp.:	-13° to 113° F (-20° to 45° C)
Humidity:	0 - 95% non-condensing
Dimensions:	2.5in x 2.5in x 3.6 in (63.5mm x 63.5mm x 91mm)
Weight:	0.9 lbs (0.41kg)
Housing:	Powder Coated Aluminum Extrusion (1/8" wall)
Approvals:	FCC Class A Radiated and Conducted ETL / UL Standards 1573 and 8750 cETL / CSA C22.2 #166-M1983 CE / IP20 Rated

PICA CUBE ACCESSORIES

Top Hat
Egg Crate Louver
Barn Doors (Set of 4)
Mounting Hardware
Symmetrical Diffusers
Asymmetrical Diffusers
Wall Power Adapter
Pica Portal 125

PART NUMBERS

UV Black:	515 90200 1075
-----------	----------------

WHAT'S IN THE BOX

Pica Cube
Set of Symmetrical Spread Lenses
Requires Wall Adapter or Pica Portal for power

At Full Power Without Diffuser

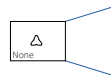

Spectral Output

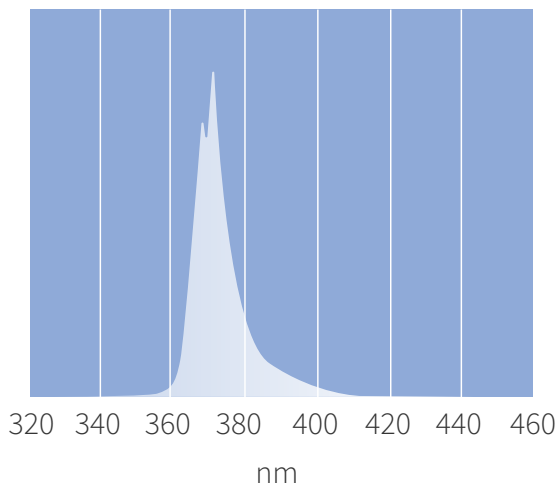

Illuminance at a Distance

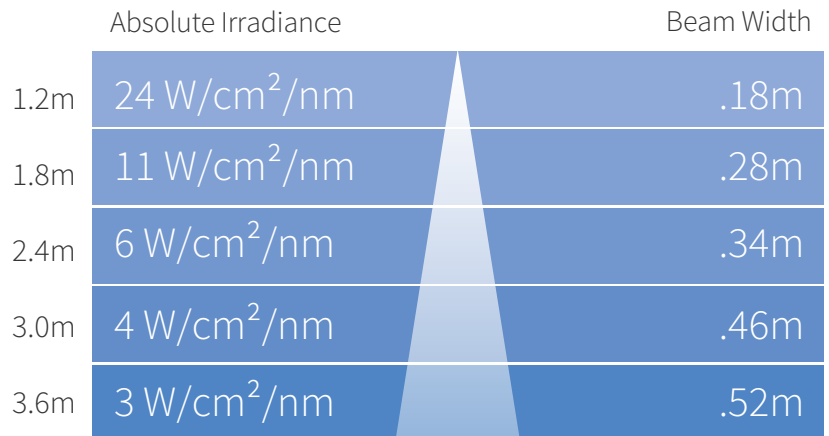

Beam Spread: 8°