

Docking Station using ListenTALK

Quick Start Guide

Introduction

Thank you for purchasing a docking station! **Please reference this guide to use ListenTALK transceivers and receivers with this product.** For ListenWIFI products, please reference the Docking Station using ListenWIFI Quick Start Guide.

The docking station allows for easy charging and management of ListenTALK transceivers and receivers. This guide provides an overview of the docking station and does not include all features or options. For complete details on care and use, please visit the ListenTech.com website to download the ListenTALK user manual.

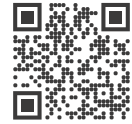

www.listentalk.com/support

Docking Station 4
LA-482



Docking Station 16
LA-480



Docking Station Case 16
LA-481



Visit the ListenTech.com website to order accessories.

Setup and Charging

1. Place the docking station on a flat surface or counter where receivers are easily accessible. Alternatively, the docking station can be mounted to a wall or other surface using the wall mounting slots (LA-480 and LA-482).
2. Connect the docking station to a power outlet using the provided power supply.
3. Insert your ListenTALK transceivers and receivers into the charging pockets of the docking station. The receiver(s) top LED status will begin flashing to indicate the battery is charging and turn solid when fully charged.

Note: Do not close the docking station case when connected to power! The case must remain open to ensure proper ventilation while charging (LA-481).

Create a Group with Docking Station

Create a leader and optional sub-leader(s) by inserting red leader clips onto transceivers. Place the leader into the *red leader pocket*. Place other transceivers and receivers into participant pockets.

 **Pairing Button** – Create a ListenTALK group by momentarily pressing the docking station *pairing button*. The *pairing indicator* will flash during pairing, then turn solid momentarily and finally extinguish when the pairing process is completed successfully. Create multiple, independent ListenTALK groups by repeating this process with additional units.

Note: Each ListenTALK group is independent and communication is secured by a unique pair key.

New Pair Key – To create a new pair key, insert leader into leader pocket and other transceivers into participant pockets in the docking station. Press and hold the *pairing button* for five seconds. The *pairing and status indicators* will flash momentarily, turn solid, and then extinguish indicating success.

Leader Clip Storage

Leader clips are only required for leader and sub-leader transceivers. Remove leader clips from participant transceivers and place them in the docking station *leader clip storage* slots for future use.

ListenTALK Status

i Status Button – Press and hold the docking station *status button* to illuminate the transceiver graphic displays for group identification and other transceiver information.

LA-382 Intelligent Cable Management Unit

A cable management unit is available for conveniently storing headsets, headphones, neck loops, and other accessories (available for LA-480 only).



User Check-Out

Docking Station Pockets – Place a credit-card sized I.D. in the docking station pocket to identify the person currently using that specific ListenTALK Transceiver.

ListenTALK Software Suite – Use check-out mode to identify the person currently using a specific ListenTALK Transceiver.

Programming

Connect a Windows® PC to the docking station USB port. Download and install the ListenTALK Software from www.listentalk.com/support. For software operation details, consult the software help files.

Docking Station - Top and Bottom

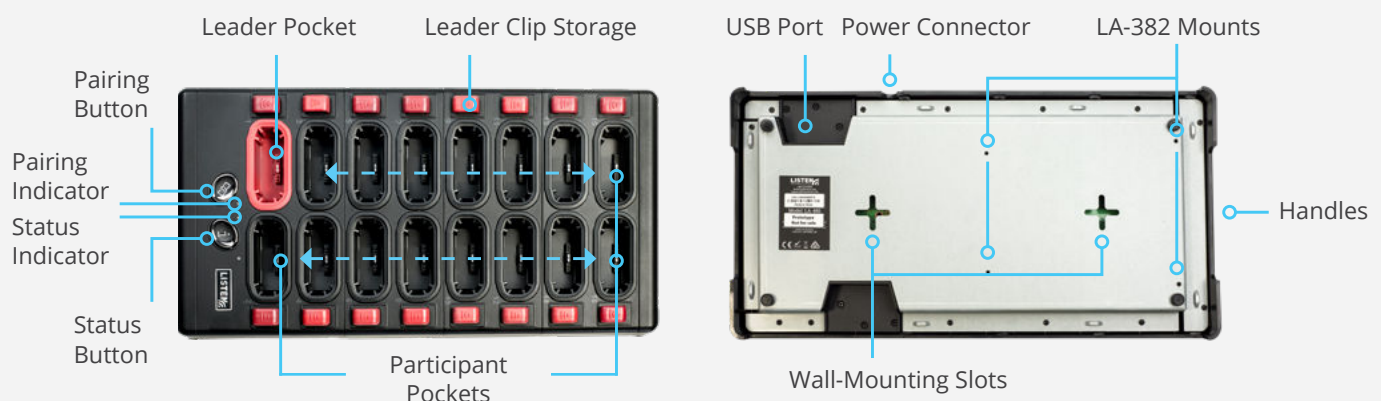

Note: mounting slots and handles are not accessible on Docking Station Case



LISTEN TECHNOLOGIES 14912 Heritage Crest Way, Bluffdale, Utah 84065-4818 USA
Phone: +1.801.233.8992 Toll-Free: 1.800.330.0891 www.listentech.com

Windows® is a trademark of the Microsoft group of companies.
Copyright © 1998 - 2023 Listen Technologies Corporation. All rights reserved. 20230807.